

Industrial Air of Texas Model CA1

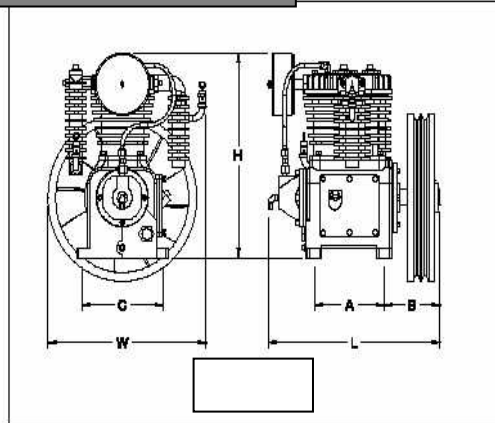

Performance			
Motor	HP	7.5	8.5
	KW	5.48	6.10
Pressure	psi	145	175
	bar	1.0	1.21
Cylinders		2	2
Piston LP	inch	4.13	4.13
	mm	105	105
Piston HP	inch	2.16	2.16
	mm	55	55
Stroke	inch	3.5	3.5
	mm	89	89
RPM		1100	1140
Displacement	DCFM	29.9	31
	m3/min	.85	.88
Air Delivered	ACFM	21.7	21.7
	m3/m	.62	.62
Efficiency %		72.5	70
Flywheel Dia.	inch	17	17
	mm	430	430
Groove Type		1/B	1/B

Dimensions			
A	inch	7.75	
	mm	197	
B	inch	5.63	
	mm	1.44	
C	inch	9.0	
	mm	229	
L	inch	18	
	mm	457	
W	inch	17	
	mm	432	
H	inch	20	
	mm	508	
Weight	kg	102	
	lb	225	
QTY 20" container			144
QTY 40" container			216

LEGEND

1HP=.7457KW 1 inch=25.4mm 1 Bar=14.5psi 1KG=2.205lbs
Cu. Meter=35.3CFM

Industrial Air of Texas Model CA1

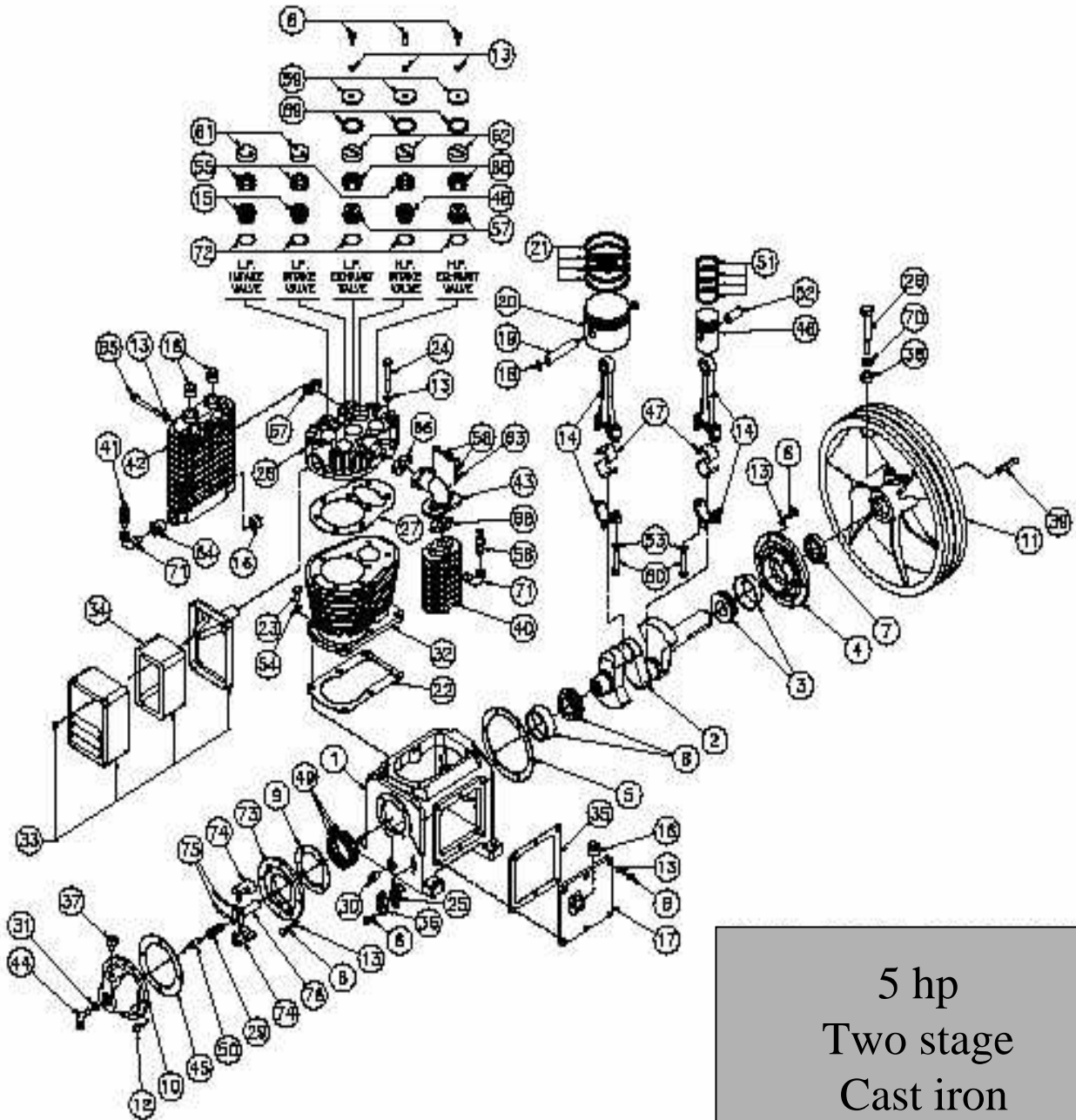

5 hp
Two stage
Cast iron
Model CA1

Item	IAT Part #	Description	QTY
1	049-0027	Crankcase	1
2	053-0051	Crankshaft	1
3	051-0053	Bearing Set Front	1
4	045-0044	Front Bearing Carrier	1
5	046-0168	Gasket Front Cap	1
6	059-0166	Capscrew Hex M8X20	21
7	046-0179	Seal -Shaft	1
8	051-0054	Bearing Set Rear	1
9	046-0227	Gasket Rear Cap	1
10	077-0071	Centrifugal Adapter Plate	1
11	044-0037	Flywheel 16 7/8"	1
12	059-0156	Capscrew Skt HD M6X20	4
13	060-0061	Gasket Copper	14
14	047-0054	Rod Connecting Aluminum w/bushing	2
15	043-0098	Valve Assembly-LP Inlet	2
16	062-0006	Plug Oil Fill-3/4" NPT	4
17	077-0069	Cover Crankcase Side	1
18	054-0119	Snapping Internal	2
19	052-0027	Wristpin- LP Piston	1
20	048-0054	Piston LP 105mm	1
21	054-0179	Piston Ring Set LP	1
22	046-0167	Gasket Cylinder To Crankcase	1
23	059-0159	Capscrew Hex 10 X 25	6
24	059-0167	Capscrew Hex 12 X 70	8
25	046-0178	Gasket Sight Glass	1
26	059-0163	Capscrew Hex 16 X 80	1
27	046-0166	Gasket Cylinder Head	1
28	042-0055	Head Cylinder	1
29	055-0051	Spring Unloader	1
30	062-0004	Plug Oil Drain-3/8" NPT	1
31	058-0084	Nut Adjustment Lock	1
32	050-0030	Cylinder	1
33	019-0097	Filter Inlet Assembly	1
34	019-0023	Filter Element	1
35	046-0169	Gasket Side Cover	1
36	032-0031	Flanged Sight Glass	1
37	056-0018	Breather	1
38	058-0086	Nut Hex-M16	1
39	146-0015	Key Flywheel	1
40	082-0014	Aftercooler	1
41	136-0046	Valve Safety 75 PSI	1
42	082-0012	Intercooler	1
43	083-0009	Elbow Aftercooler	1
44	031-0057	Elbow Valve and Unloader	1
45	046-0171	Gasket Unloader Cover	1
46	048-0081	Piston-HP	1
47	051-0055	Insert Rod-Bearing Half	4
48	043-0100	Valve Assembly-HP Inlet	2
49	046-0177	Shim .015 Brg Adjustment	A/R
49	046-0176	Shim .010 Brg Adjustment	And/Or
49	046-0175	Shim .005 Brg Adjustment	And/Or
50	078-0011	Plunge Unloader	1
51	054-0178	Set HP Piston Rings	1
52	052-0028	Wristpin HP Piston	1
53	060-0072	Lockwasher 10	4
54	060-0063	Gasket Copper	6
55	043-0094	Spacer Inlet Valve	3
56	136-0007	Valve Safety 200 PSI ASME	1
57	043-0100	Valve Assy HP/LP Discharge	2
58	059-0158	Capscrew SKT Head 8 X 25	4
59	077-0073	Cover Valve	3
60	059-0154	Capscrew SKT Head M10x45	4
61	058-0082	Retainer Inlet Valve	2
62	058-0083	Retainer Discharge Valve	3
63	060-0070	Lockwasher 8	4
64	063-0006	Bushing Reducing 3/4"M X 1/4"F NPT	1
65	059-0157	Capscrew Hex M8X85	4
66	046-0172	Gasket Aftercooler	2
67	046-0173	Gasket Intercooler	2
68	043-0095	Spacer Discharge Valve	2
69	046-0174	Gasket Valve Cover	3
70	060-0069	Lockwasher 16	1
71	064-0022	Elbow Street 90 Degrees 1/4"	2
72	060-0062	Copper Valve Seat Gasket	5
73	077-0070	Cap Rear	1
74	096-0009	Weight Unloader	2
75	107-0015	Pin - Hinge	2
76	114-0012	Holder Unloader	1
77	046-0183	Gasket Set	1